

PowerG[®] EXPLOSIVE DRAWING

Petrol brush cutter--GDB30B

File: 0020100902BC

Version: 1.0

Date: 26th Oct, 2010



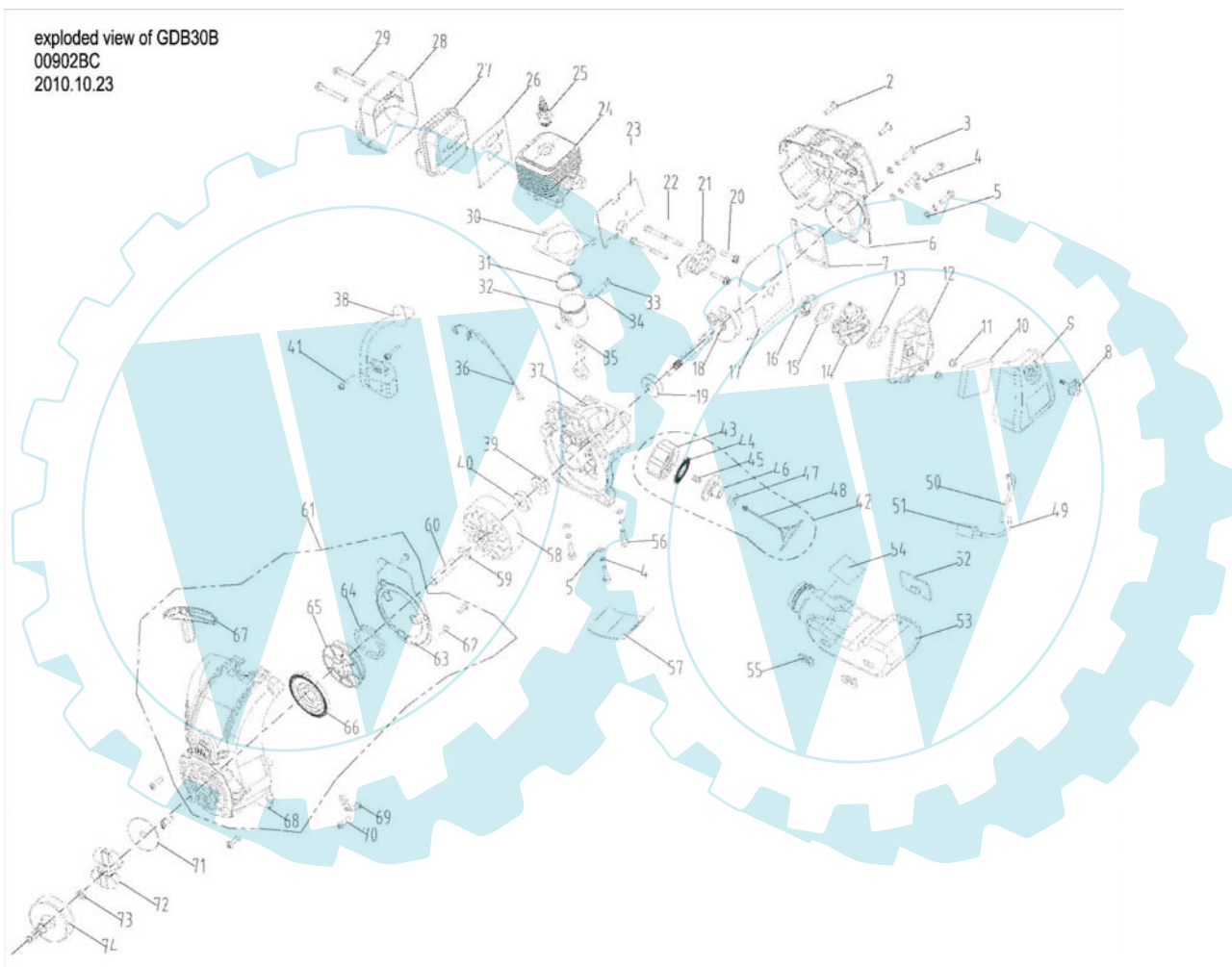



File:0020100902BC

Version: 1.0

Petrol brush cutter-GDB30B

Pos. No	Part code	English	QTY
1	902906	engine assy	1
2	B42201F	tapping screw s14.8x20	2
3	B345006	torx screw M5x20	4
4	B500005	spring washer 5	12
5	B504005H	washer 5	11
6	901100	rear cover	1
7	901130	gasket-rear cover	1
8	901001	screw assy-rear cover	1
9	901002	air filter cover	1
10	901305	air filter	1
11	B229002	Hexagon nut M5	2
12	901003	filter support	1
13	901306	gasket-rear	1
14	901800A	carburetor	1
15	901307	gasket-carburetor	1
16	901004	intake seat	1
17	901308	gasket-intake seat	1
18	902201	crankshaft assy	1
19	B700419	ball bearing 6201/P53	1
20	B345013	torx screw M6x23	2
21	901005	intake seat	1
22	901234	Hexagon head bolt M6x62	2
23	901309	gasket-intake seat	1
24	901212	cylinder	1
25	902700	spark plug NHSP LD L8RTF	1
26	901304	gasket-cylinder	1
27	901213	muffler	1
28	901214	rust screw	1
29	901233	screw assy M5x50	2
30	901303	gasket-cylinder	1
31	901206	piston ring	2
32	901205	piston	1
33	901208	ring-piston pin	2
34	901207	piston pin	1
35	901210	connecting rod assy	1
36	901700A	engine case assy	1
37	901211	crankcase	1
38	901704	ignition coil	1
39	901902	oil seal 12x28x7	1
40	B700414	ball bearing 6001-2RS/P53	1
41	901235	torx screw assy M4x20	2
42	901031	rust cap assy	1
43	901030	fuel cap	1
44	901310	gasket-fuel cap	1
45	900310	vent	1
46	902005	vent base	1
47	902004	cap-retainer	1
48	901026	retainer-fuel cap	1
49	901315	inlet fuel hose	1
50	900314	outlet fuel hose	1
51	901313	fuel filter	1
52	901312	bumper 2	1
53	901009	fuel tank	1
54	902907	silver adhesive paper	1
55	901311	bumper 1	2
56	B34023	lock screw M5x20	3
57	901301	gasket-fuel tank	1
58	901703	flying wheel	1
59	902222	spacer	1
60	902205	orientation tube	1
61	901032	starter assy	1
62	B42201F	tapping screw s14.2x12	3
63	901222	starter plate	1
64	901314	starter rope	1
65	901207	starter pulley	1
66	901505	starter spring assy	1
67	901008	starter grip	1
68	901033	starter cover	1
69	901203	throttle frame	1
70	B345012	torx screw M5x18	4
71	902204	clutch-spacer	1
72	902203	clutch-body assy	1
73	B282014	E rings	1
74	902202	clutch-hub assy	1
75	B304024	Hexagon socket head cap screws M6x25	2
76	B504006H	washer 6	6
77	B500006	spring washer 6	6
78	B422009F	tapping screw s15.5x20	4
79	B217004	Prevailing torque type hexagon nuts	2
80	902006	Clamp-Drive Shaft Tube	1
81	902246	upper tube assy	1
82	901239	serrated lock washer	4
83	902229	washer	1
84	901278	upper flexible shaft	1
85	901018B	upper plastic support	1
86	901202	washer	2
87	902500	spring	1
88	901228	collar-flexible shaft	1
89	901226C	upper tube	1
90	901317	spacer	1
91	901229	coupler	1
92	901020	knob assy	1
93	902200	hanging ring	1
94	B305001	Hexagon socket head cap lock screws M6x15	1
95	902300	shoulder-harness assy	1
96	902241	lower tube assy	1
97	901018B	lower plastic support	1
98	902239	lower tube	1
99	901218B	lower flexible shaft	1
100	902701	throttle cable assy	1
101	902016	left handle-U handle	1
102	902230	tube-U handle	1
103	B304024	Hexagon socket head cap screws M6x25	2
104	902233	arc block03	1
105	902307	cushion-arc block	2
106	902232	arc block02	1
107	902231	arc block01	1
108	B304024	Hexagon socket head cap screws	4
109	B304022	inner Hexagon screw M6X35	1
110	902012	right half of right handle	1
111	902017	throttle lock	1
112	902501	spring-button	1
113	B282008	"E" rings 5	1
114	901706	stop switch	1
115	B504004H	washer 4	4
116	B400002	Cross recessed pan head tapping screws ST2.9X6.5	2
117	B400004	Cross recessed pan head tapping screws ST2.9X9.5	7
118	902015	guide block	1
119	902013	lockout button	1
120	902503	spring-lockout button	1
121	902011	left cover-rear handle	1
122	902014	throttle trigger	1
123	902502	spring-throttle trigger	1
124	B201002	Hexagon nut M6	1
125	B345004	Torx screw M5X12	1
126	B304019	inner Hexagon screw M6X30	1
127	902237	gear box assy	1
128	B276016	Hole Snap Ring 24	1
129	B278007	Axial Spring Collar 9	1
130	B700429	ball bearing 609-Z	1
131	B700430	ball bearing 609	1
132	902214	drive shaft	1
133	902213	body-gear box	1
134	B436006	Hexagon head cap screw M6x12	1
135	B700410	ball bearing 6000p53	1
136	902215	driven gear	1
137	902216	drive gear	1
138	B700419	Ball Snap Ring 32	1
139	B276022	Hole Snap Ring 32	1
140	902217	tube	1
141	902217	blade	1
142	902003	cutler guard	1
143	B500004	spring washer 4	3
144	B304020	inner Hexagon screw M4X12	3
145	902218	active spacer	1
146	902221	blade	1
147	902008	Knife sheath	3
148	902219	clamp spacer	1
149	902223	Hexagon nut assy M10	1
150	9029025	inner hexagon spanner 5	1
151	9029024	inner hexagon spanner 4	1
152	9029023	inner hexagon spanner 3	1
153	902900	Socket wrench	1
154	901025	attachment hanger	1

REMARKS

- The above quotations are based on RMB/EUR=0.2170.
- If RMB value increase over 5%, the prices should be adjustable.
- 2.If main material fluctuated more than 5%,the prices should be adjustable
3. Prices normally valid for one year from the day we offer,except the case we consider it invalid.
- 4.All prices should be subject to our final confirmation.